

Website: <http://www.embedia.com>

Email: [support@embedia.com](mailto:support@embedia.com)

Phone: +1-403-456-6279

## USBIF-WiFi



Embedia InSight Adapter (USB WiFi)

## Package Contents

- 1 x Embedia InSight Adapter (USB WiFi)
- 1 x 0.5m (1.6ft) Micro-A to Micro-B USB Cable

## Overview

The USBIF-WiFi allows the Embedia InSight App to connect to a Solarai™ system.

Optionally, the USBIF-WiFi can be connected to an existing WiFi network and allow the Embedia InSight App to connect to a Solarai™ system through that WiFi network.

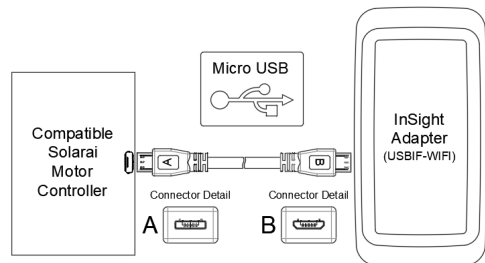

## Before You Begin

You will need the following tools and accessories:





- Embedia Solarai™ Group or Plus Motor Controller
- Embedia InSight App (free download)

## Mounting Details

The USBIF-WiFi should be connected to a Group or Plus Solarai™ motor controller and placed anywhere OUTSIDE of its junction box as it is a low voltage DC device with wireless signals that the junction box could interfere with if it were placed inside.

## Wiring Details

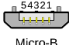
The USB cable that is included has 2 types of connectors: Micro-A (rectangular-shaped) and Micro-B (trapezoidal-shaped). The micro-A connector connects to any Embedia Group or Plus motor controller that has a USB port and will not fit into the USB port of the USBIF-WiFi. The Micro-B connector will fit into either USB port, but it must be connected to the USBIF-WiFi for proper operation. The length of the included cable is selected based on typical usage but can be replaced with a cable of a different length. Various USB cable lengths are available for optional purchase. The USBIF-WiFi should be located no further than 5m (15 ft) from the controller, which is the maximum cable length supported by USB.

Embedia Motor Controller USB Port	Micro-A Connector	Micro-B Connector	USBIF-WiFi USB Port
 Micro-AB	 Micro-A	 Micro-B	 Micro-B

## Setup

Note that it can up to 2 minutes before the USBIF-WiFi is ready to accept connections after plugging it into a Solarai™ controller.



The QR Code on the USBIF-WiFi can be scanned using the default camera app on a phone or tablet to set up the WiFi network connection. Alternatively, or if the camera app is unable to scan the QR code, manually select the name of the WiFi network that matches the "SSID" on the label from your phone or tablet's WiFi connection menu and enter the password printed on the label to connect.

Once connected, you will be prompted to "Sign In" to the WiFi network. Tap the "Sign In" prompt and you will be directed to a screen where you can optionally connect the USBIF-WiFi to an existing WiFi network. The USBIF-WiFi will operate without being connected to another WiFi network, but by connecting it to another WiFi network, you can access your shade network from that WiFi network without having to connect to the USBIF-WiFi directly from your phone or tablet.

The Embedia InSight App can be used to explore and configure the system when you are directly connected to the USBIF-WiFi, or through the WiFi network that you configure the USBIF-WiFi to connect to.

## Embedia InSight App



Android	iOS
 GET IT ON <b>Google Play</b>	 Download on the <b>App Store</b>

## Technical Specifications

Parameter	Specification
Power and Communication	USB Micro B; 5Vdc Connect to a Solarai™ Group or Plus motor controller using a USB Micro A to Micro B cable (5m/15ft max)
Dimensions	91mm (3.58") x 46.5mm (1.83") x 18mm (0.71")
Enclosure	ABS plastic enclosure

